



# Bau- & Hausbesichtigung

**Bungalow WFL ca. 100 m<sup>2</sup>**

**Wo:** 14656 Brieselang

**Wann:** Nach Abstimmung

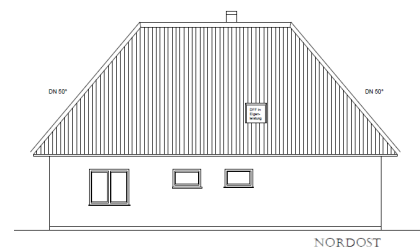
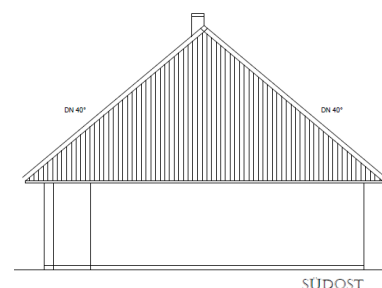
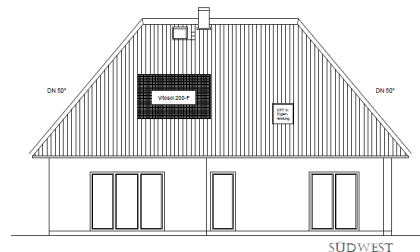
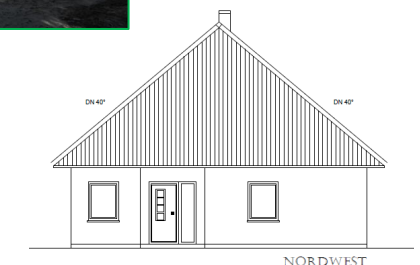
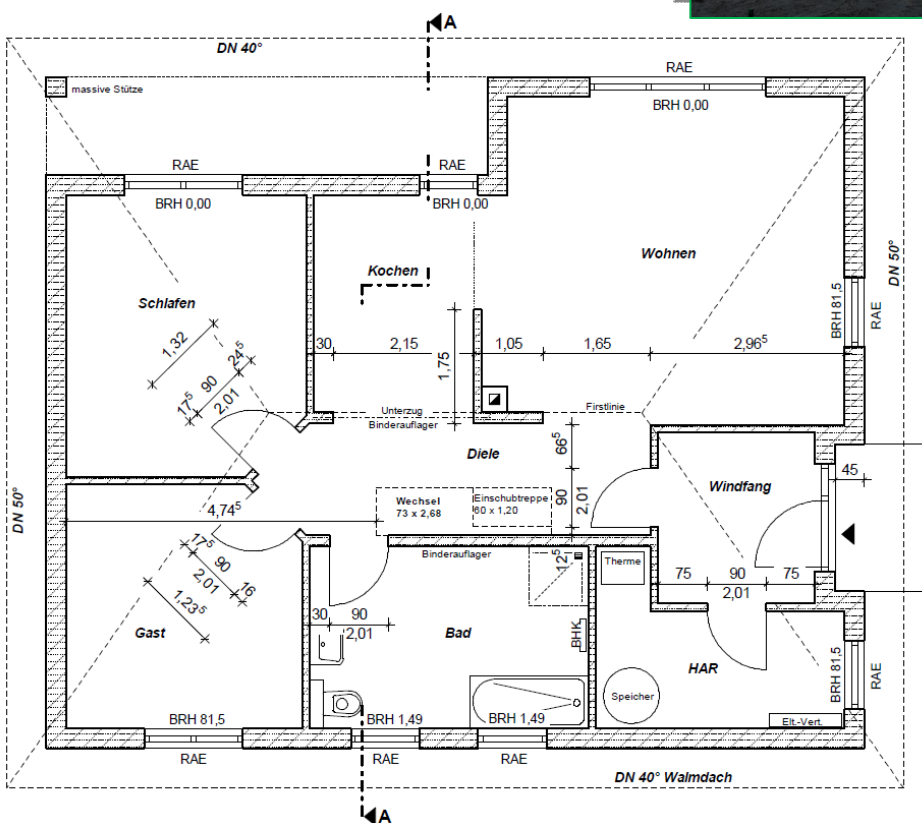

**Ein Bungalow, individuelle Planung, Wohnflächen ca. 100 m<sup>2</sup>:**

**Windfang 6,29 m<sup>2</sup>**

**Diele 9,70 m<sup>2</sup>**

**Wohnen 27,06 m<sup>2</sup>**

**Kochen 8,16 m<sup>2</sup>**

**Schlafen 15,41 m<sup>2</sup>**

**Gast 13,12 m<sup>2</sup>**

**Bad 11,89 m<sup>2</sup>**

**HWR 7,66 m<sup>2</sup>**

**Im Dachgeschoss mit Ausbaureserve**



Elbe Haus<sup>®</sup> - Beratungsbüro Berlin Brandenburg

Im „Havel Park Dallgow“ - 14624 Dallgow, Döberitzer Weg 3

Telefon: 033232 / 22 647 - Funk: 0172 / 39 39 0 13 - E-Mail: O.Schlaak@elbe-haus.de